

DSD

DESCRIPTION

AMC MECANOCAUCHO® DSD mounts design provides excellent radial and axial flexibility making them most suitable for the suspension of machines where isolation of both vertical and horizontal vibration components occur .

DSD mounts comprise of two flat metal parts. Top metal part is circular with either a tapped central hole or interior welded nut for attachment to the machine frames. Lower metal part has an oval contour with two machined holes, one at each end, to securely attach the mountings to the support structure for the machine.

OPERATION AND ASSEMBLY

Both metal parts are fully bonded to the dome shaped circular rubber section during moulding.

The rubber section works in compression when loaded. In the event of shock inputs or accidental overloads the mountings will deflect vertically and horizontally, absorbing the energy.

It is highly recommended that the metal Cups shown below are used on assembly to produce the progressive stiffening under dynamic load inputs.

Attachment of the mounts to the support structure can either be by the use of Set Screws, Bolts or by adapting the support structure to have threaded pins bonded / welded or previously grouted to the floor as in the case of concrete slabs.

For applications where high vibration isolation is needed, the DRD mounts should be referred to.

TECHNICAL CHARACTERISTICS

DSD mountings comparable stiffness vertically and horizontal making them very effective against random vibrations in either plane.

ADVANTAGES

- Simple to install, can be placed directly on the floor or ground due to the vertical flexibility of the rubber section without direct attachment.
- Effectiveness – with three standard compounds available, identified by the hardness stamped on the base, Soft: hardness A 45, Medium: hardness B 60, Hard: hardness C 75), enabling the user to choose the most suitable mount for the load to be supported and the vibration frequency.
- For extremely low vibration frequencies they can be mounted in series to provide additional vibration isolation, in certain cases it may be advisable to install an effective "Fail Safe" design to prevent over deflection.
- Speed of placement of the mount and easy movement of the machine to the required spot.
- Cost effective.

APPLICATIONS

DSD mountings are particularly suitable for applications with low to medium dynamic amplitudes which enables the mountings stiffness rates to provide effective isolation .

Suitable for HVAC, Ventilators, rotating pumps, torque or frequency converters, electrical engines, etc.



ASSEMBLY

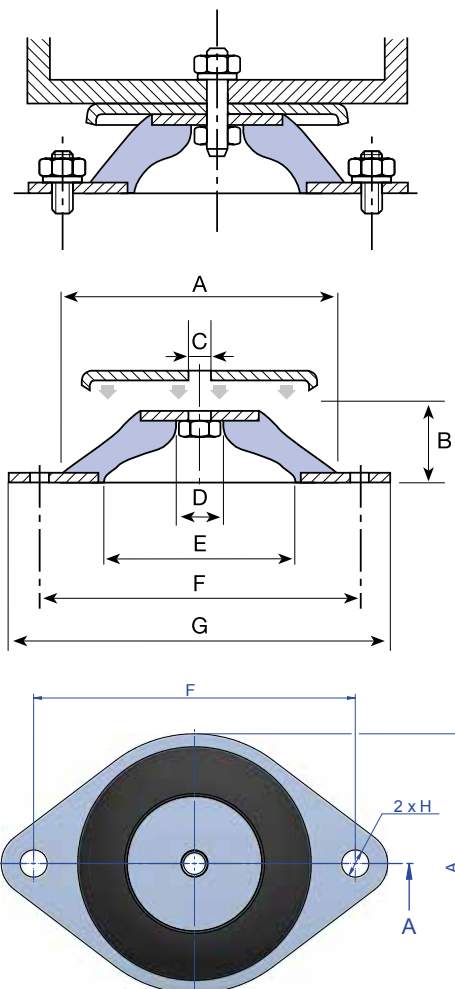

Type	A (mm.)	B (mm.)	C	D (mm.)	E (mm.)	F (mm.)	G (mm.)	H (mm.)	Weight (gr.)	Code	Load (Kg.)	Shore
DSD 40 + Washer	43	20	M6	19	29	52	64	6,25	27	134028	4	45 Sh
										134029	10	60 Sh
										134030	15	75 Sh
DSD 60 + Washer	60	24	M6	14	39	76	95	6,5	78	134031	15	45 Sh
										134032	25	60 Sh
										134033	45	75 Sh
DSD 80 + Washer	86	27	M8	25	65	100	120	8,5	146	134034	75	45 Sh
										134035	110	60 Sh
										134036	150	75 Sh
DSD 100 + Washer	100	28	M10	22	67	124	149	10,5	274	134037	90	45 Sh
										134038	160	60 Sh
										134039	220	75 Sh
DSD 150 + Washer	150	39	M14	34	115	182	214	12	703	134040	130	45 Sh
										134041	250	60 Sh
										134042	350	75 Sh
DSD 200 + Washer	200	44	M18	35	140	240	280	15	1758	134043	500	45 Sh
										134044	825	60 Sh
										134045	1250	75 Sh

Type	A (mm.)	B (mm.)	C	D (mm.)	E (mm.)	F (mm.)	G (mm.)	H (mm.)	Weight (gr.)	Code	Load (Kg.)	Shore
DSD 40	43	17,3	M6	19	29	52	64	6,25	27	134001	4	45 Sh
										134002	10	60 Sh
										134003	15	75 Sh
DSD 60	60	23	M6	14	39	76	95	6,5	78	134004	15	45 Sh
										134005	25	60 Sh
										134006	45	75 Sh
DSD 80	86	25	M8	25	65	100	120	8,5	146	134007	75	45 Sh
										134008	110	60 Sh
										134009	150	75 Sh
DSD 100	100	25	M10	22	67	124	149	10,5	274	134010	90	45 Sh
										134011	160	60 Sh
										134012	220	75 Sh
DSD 150	150	34,5	M14	34	115	182	214	12	703	134013	130	45 Sh
										134014	250	60 Sh
										134015	350	75 Sh
DSD 200	200	40	M18	35	140	240	280	15	1758	134016	500	45 Sh
										134017	825	60 Sh
										134018	1250	75 Sh

NATURAL FREQUENCY
 AMC MECANOCAUCHO® DSD TYPE

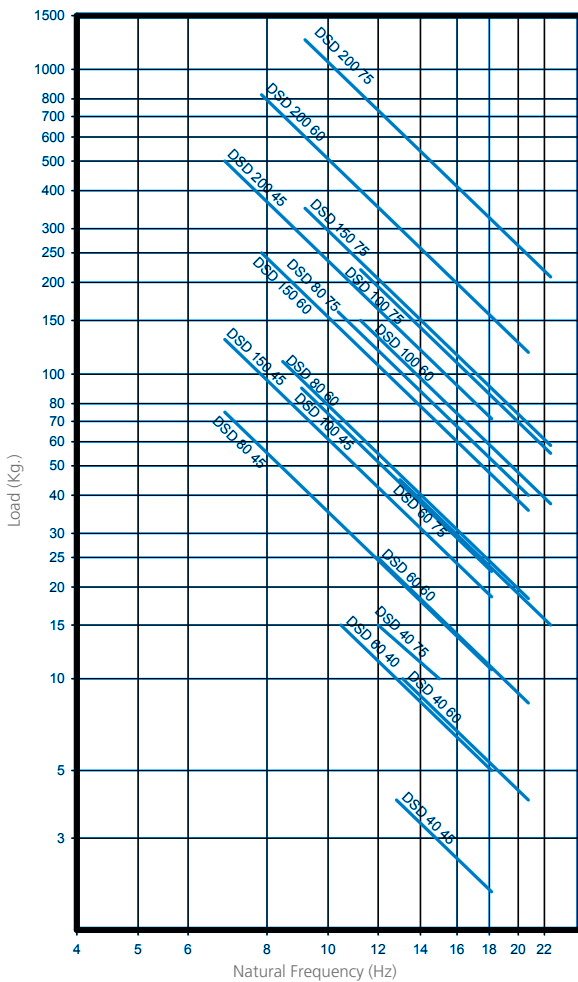

LOAD DEFLECTION GRAPH
 AMC MECANOCAUCHO® DSD TYPE

